

3900 Metal Toggle Switches 16A 250Vac - IP67 Sealed Versions



- ▶ Metal toggle switches
- ▶ Ratings up to 20A, 125/277V ac
- ▶ Single and double pole
- ▶ Choice of circuits including 3 position and momentary
- ▶ Sealed version supplied complete with gaskets
- ▶ Panel seal version to IP67
- ▶ 3 Terminal Options
- ▶ Guard option



16(4)A 250Vac T85 (3900 & 3950)
10(4)A 250Vac T85 (All other circuits)



UL CSA* 20A 125/277Vac (ON-OFF Circuits)
UL CSA* 16A 125/277Vac (Other Circuits)
UL CSA* 7A 72Vdc, 14A 36Vdc
UL 250Vac 1hp, 125Vac 1/2hp
UL 65°C, file E45221, CSA file LR10990



RoHS compliant

Approvals and ratings vary with function.
3mm contact gap except where marked μ .
Technical data on pages 4 & 5.
* CSA approval for A and B bodies only

ORDER FORMAT

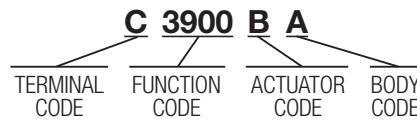

TERMINAL	FUNCTION	ACTUATOR
C 6.3 x 0.8 10.5	Single pole 3900 ON - OFF 3901 ON - OFF (momentary ON) 3902 ON - OFF (momentary OFF)	Double pole 3950 ON - OFF 3951 ON - OFF (momentary ON) 3952 ON - OFF (momentary OFF)
S 10.5 Screw & clamp	3910 ON - ON 3911 ON - ON (momentary 1 side) 3920 ON - OFF - ON μ	D 25.4 metal E 38.1 metal
T 10.5 Ø3.1 Solder	3921 ON - OFF - ON μ (momentary 1 side) 3922 ON - OFF - ON μ (momentary 2 sides)	F 17.5 nylon Switches with F toggles have double pole bodies, regardless of circuit Metal toggle finish is nickel plate

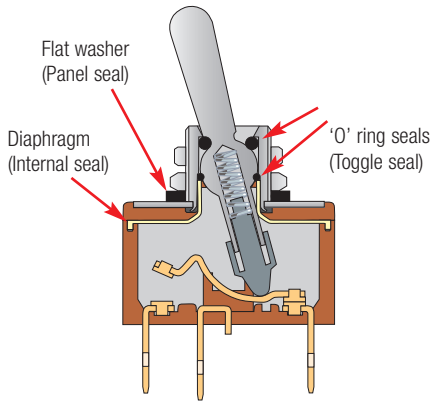

Toggle switch - sealed version
BE and BF types



Guard TG1-RED
Anti-rotation tab can be specified
for guard fitted in On or Off position
(Guard is suitable for On Off switches only)



C3900BE ---



C3920BA ---



C3950BF ---



C3972BB ---

toggle
switches

BODY

A
Single pole

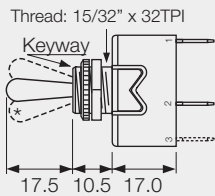

E
Panel sealed, single pole

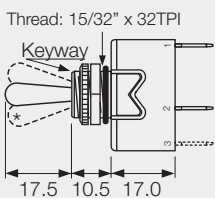

B
Double pole

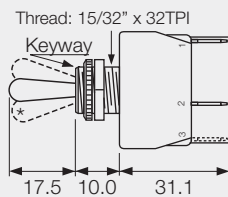

F and G
Panel sealed, double pole
F with barriers, G without barriers

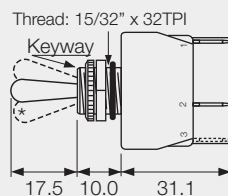

OPTIONS

Switch Boot

(B Actuator only)
Rubber
-57T145



Switch Boot

(B & C Actuators)
Rubber
-57T145



Boots have internal brass or nylon nuts

Mounting nuts

Nickel plated brass are supplied

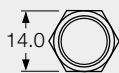

Hex Back nut



Knurled Ring nut
Panel thickness 4.0 with backnut

Plate

P236 plate SP or DP



DIMENSIONS (mm) * Indicates ON position (for ON - OFF switches)

Single Pole

(C terminals shown)

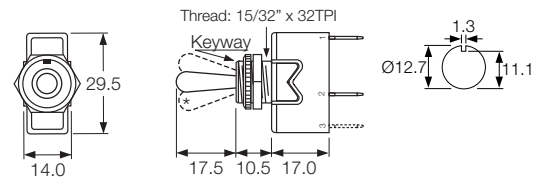

A Body

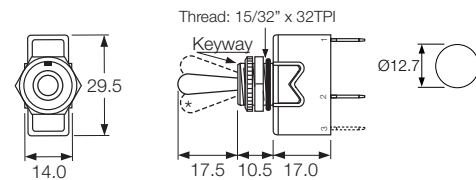

E body (panel sealed)

Double Pole

(C terminals shown with barrier)

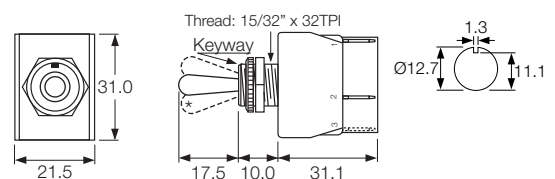

B Body

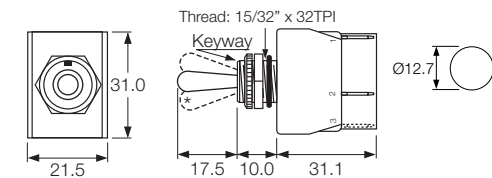

F body (panel sealed)

1700 & 1750 Toggle Switches 16A 250Vac Single and Double Pole



- ▶ Nylon toggle switches
- ▶ Ratings up to 20A, 250V ac
- ▶ Single and double pole
- ▶ Wide choice of terminals
- ▶ Choice of circuit options including 3 position
- ▶ Flat & round actuator options



16(4)A 250Vac T85



UL 20A 250Vac Non Ind (Single pole)
 UL 16A 250Vac Non Ind (Double pole)
 UL CSA (2 pos types) 250Vac 1hp, 125Vac 1/2hp
 UL CSA (3 pos types) 250Vac 1/2hp, 125Vac 1/4hp
 CSA 16A 250Vac Non Ind
 UL 85°C, file E45221, CSA file LR10990
 UL and CSA N/A on momentary types

In house test

Inrush 36A to EN61058-1 & 20A 28Vdc



RoHS compliant

Selective "A, B, C" and "OFF, A, A+B" circuits at 5 amp also available.
 3mm contact gap except where marked μ .
 Technical data on pages 4 & 5.

ORDER FORMAT

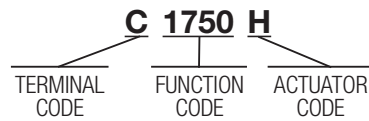

TERMINAL	FUNCTION	ACTUATOR
C 6.3 x 0.8	Single pole 1700 ON - OFF	Double pole 1750
H 4.8 x 0.8	1710 μ ON - ON	1760 μ
K 2.8 x 0.8	1720 μ ON - OFF - ON	1770 μ
T Solder	1721 μ ON - OFF - ON (momentary 1 side)	The switch is on between centre terminals (2 & 5) and the terminals over which the lever is positioned.
X PCB 0.8 Sq	1722 μ ON - OFF - ON (momentary 2 sides)	



C1700R --



C1700H --



C1760R --



C1750H --

BODY

0
Single pole

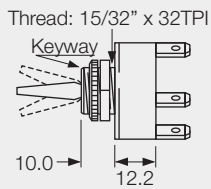

0
Double pole

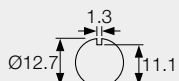
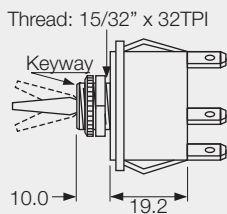

Panel hole (all types)
Panel thickness (Max)
Both nuts - 3.5mm
Less backnut - 6.5mm

OPTIONS

Neck Seal M539
Material - Nitrile
(H & R Actuators)
Actuator visible



Cover M1080
Material - EPDM
(R Actuator only)



Cover M331
Material - PVC
(R Actuator only)



Covers have internal nylon nuts

Fixing nuts (Standard is M506 & T92)

T5 Hex brass
M506 Hex nylon

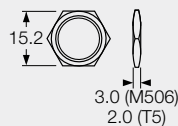

T92 Knurled brass - slotted

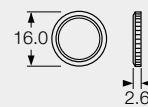

M279 Knurled nylon

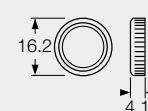

DIMENSIONS (mm)

Single Pole

(C terminals shown)

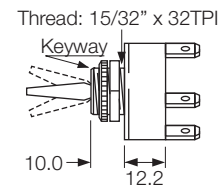
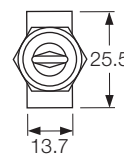

Optional
P236 plate
SP or DP

Double Pole

(C terminals shown)

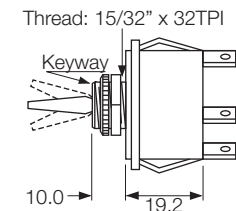
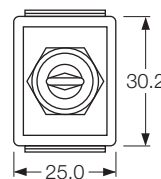

Without barrier

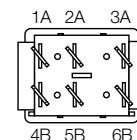

With barrier

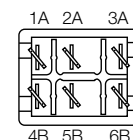

Optional terminal barrier M441.

0600 Toggle Switches 1A 250Vac



C0600HD - - -



C0600CC - - -

- ▶ Toggle switch
- ▶ Brass and nylon actuators
- ▶ Single pole
- ▶ Latching and momentary action
- ▶ Choice of actuator profiles



C0602SC - - -

In house test

1A 250Vac
3A 12/24Vdc

RoHS

RoHS compliant

3mm contact gap.
Technical data on pages 4 & 5.

ORDER FORMAT

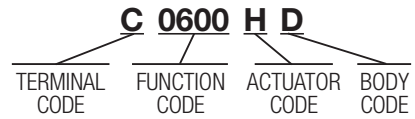

▶ TERMINAL	▶ FUNCTION	▶ ACTUATOR	▶ BODY	▶ OPTIONS
<p>C</p> <p>6.3 x 0.8 10.1</p>	<p>0600</p> <p>ON - OFF</p> <p>0602</p> <p>ON - OFF (momentary ON)</p>	<p>C Chromed brass (0600)</p> <p>15.0</p> <p>U Nylon (0600)</p> <p>12.1</p> <p>G Nylon (0600)</p> <p>27.0</p> <p>H Nylon (0600)</p> <p>17.0</p> <p>S Chromed brass stem/nylon paddle (0602 only)</p> <p>41.8</p>	<p>D Nylon neck and top plate (Used with actuator codes U, G and H)</p> <p>C Metal neck and top plate (Used with actuator codes C and S)</p> <p>Panel thickness - 3.5mm Back nut must be fitted</p> <p>Fixing nuts (Standard is M506 & T92)</p> <p>T5 Hex brass M506 Hex nylon</p> <p>15.2 3.0 (M506) 2.0 (T5)</p> <p>T92 Knurled brass - slotted</p> <p>16.0 2.6</p> <p>M279 Knurled nylon</p> <p>16.2 4.1</p>	<p>Cover M331</p> <p>(C Actuator only) PVC -5T85</p> <p>Seal M539 (C,H & U Actuators) Rubber -57T145</p> <p>Actuator visible</p> <p>Cover M1080 (C Actuator only) Rubber -57T145</p> <p>Covers have internal nylon nuts</p>

Dimensions (mm)

0600 (U actuator shown)

0602

