

8800 Thinline Rocker Switches 10A 250Vac



- ▶ Ultra thin rocker switch
- ▶ Ratings up to 15A, 250Vac
- ▶ Single and twin gang
- ▶ Bezel sizes:
 Single 21 x 9.5
 Twin 21 x 15.5



10(6)A 250Vac T100
6(2)A 250Vac T100 5E4 (50,000 Operations)
Inrush 50A to EN60065:1998



UL CSA 15A 250Vac (Twin unit is 10A 250Vac)
UL CSA 125Vac 1/2hp
UL 100°C, file E45221, CSA file LR10990

In house test

10A 28Vdc



RoHS compliant

3mm contact gap.
 Technical data on pages 4 & 5.

B BLACK
W WHITE

H 8800 V A B B 133W

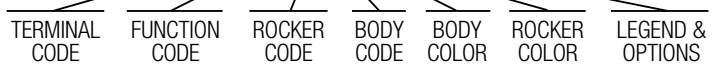

ORDER FORMAT

TERMINAL	FUNCTION	ROCKER
H 4.8 x 0.8	 Switches are ON when pressed over terminal 1	V Curved
	8800 ON - OFF Single pole	
	 Switches are ON when pressed over terminals 1 or 3	
	8800 8800 ON - OFF Twin (Single pole)	
T 3.5 x 0.8 Solder		



H8800VA
T8800VA



H8800VA
T8800VA



H8800 8800VA
T8800 8800VA



H8800 8800VA
T8800 8800VA

BODY

A Single pole

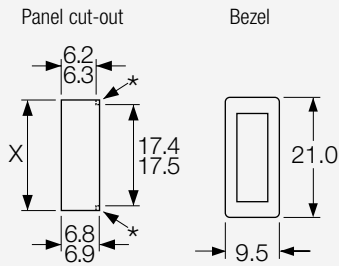

*Optional profile for orientation

A Single pole - Twin

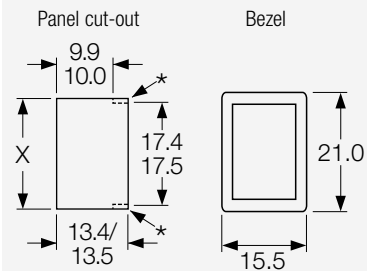

*Optional profile for orientation

Panel thickness	Dim X
0.75-1.24	19.1/19.2
1.25-1.99	19.3/19.4
2.00-3.00	19.7/19.8

Cut-outs must be punched in the direction of insertion

OPTIONS

Finish

Matt finish only

Color

Call factory for custom colors.
A full range is available for large orders

Legend printing

Select from the examples or call the factory for custom legends

Dimensions (mm)

8800VA (H terminals shown)

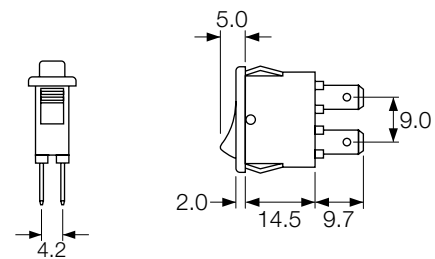

8800 8800VA (H terminals shown)

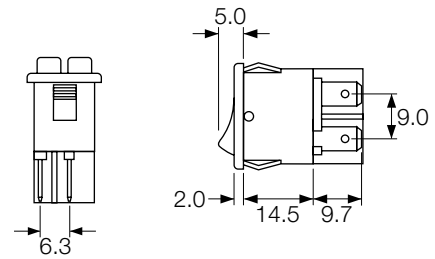

Examples of our range of legend printing

() is legend color B-Black, W-White, R-Red



132(W)



133(W)