

R13 Round Rocker Switches 6A 250Vac



- ▶ Miniature round rocker switch
- ▶ Ratings up to 10A, 250Vac
- ▶ Single & double pole
- ▶ Illuminated & non-illuminated, neon and LED
- ▶ Choice of actuators
- ▶ Matching indicator
- ▶ Bezel size: 23mm dia.



SP 6A 250Vac T85,
DP 10(4)A 250Vac T85



UL CSA SP 10A 125Vac & 6A 250Vac (For 16A call the factory)
UL CSA DP 8A 125/250Vac
UL 85°C, file E67774(S)
CSA file LR45128



RoHS compliant

Single pole has μ contact gap.
Technical data on pages 4 & 5.

Standard products

Are supplied with the body and rocker color, print & lamp voltage shown in the product illustration and description.

R13 112ABB 602AW

ORDER FORMAT

TERMINAL FUNCTION ROCKER BODY PRINT, COLOR, VOLTAGE ETC

PRODUCT DETAILS

	 SP ON - OFF μ Cat no. R13 112ABB-602AW		 SP ON - OFF μ Lit 110V Cat no. R13 112BWR2
	 SP ON - OFF μ Cat no. R13 112AWW-602AB		 SP ON - ON μ Cat no. R13 112CBB
	 SP ON - OFF μ Lit 110V Cat no. R13 112BBBR2		 SP ON - OFF - ON μ Cat no. R13 112DBB-730W
	 SP ON - OFF μ Lit 110V Cat no. R13 112BBG2		 SP ON - OFF μ (Momentary On)* Cat no. R13 208FBB
	 DP ON - OFF Lit 110V Cat no. R13 244ABB-602AW		 DP ON - OFF Lit 110V Cat no. R13 112BBR2

DIMENSIONS (mm)

Panel cut-out

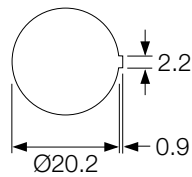

Snap fixing into panel thickness up to 3.0

Single pole

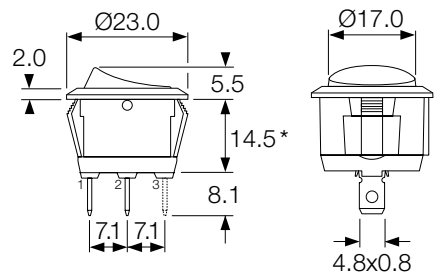

* R13 208F has 12.5mm deep body

Double pole

